



769 Singleton Road Laughtondale NSW

 5  4  2

Lifestyle Architectural Masterpiece on 38 acres

Prime flat arable land to graze, grow or enjoy. The estate has 560 metres of absolute river frontage.

Discover a lifestyle where luxury meets tranquility, in this beautifully designed architectural masterpiece, perfectly positioned to embrace the natural beauty and nature with its surroundings. Set amidst a breathtaking landscape, this stunning residence offers an unparalleled blend of contemporary elegance and relaxed living.

Step inside to soaring ceilings, expansive glass panels, and an effortless flow of light and space, creating a harmonious connection between the indoors and the lush outdoors. The thoughtfully crafted floor plan enhances every aspect of modern living, with stylish open-plan spaces, high-end finishes, and seamless entertaining areas that overlook the

[For full version visit the website](#)

Available by appointment

Type : House
Land Size : 38.25 Acres
View : <https://www.lumby.com.au/8267465>

Lloyd Jones
02 9651 2788

Kate Lumby
02 9651 2788

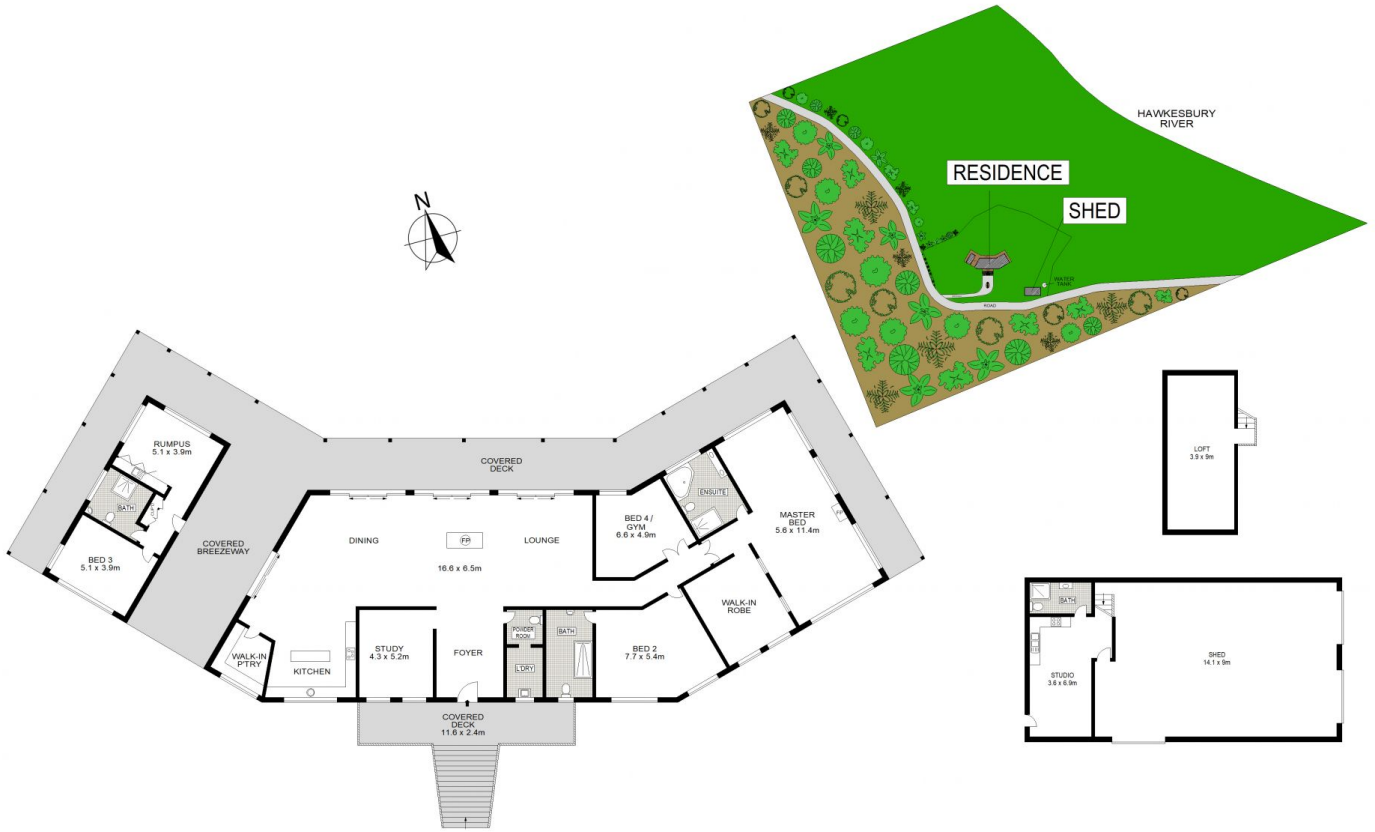

769 Singleton Road, LAUGHTONDALE

Dimensions are approximate. All information contained herein is gathered from sources we believe reliable. However, we cannot guarantee its accuracy and interested persons should rely on their own enquiries